

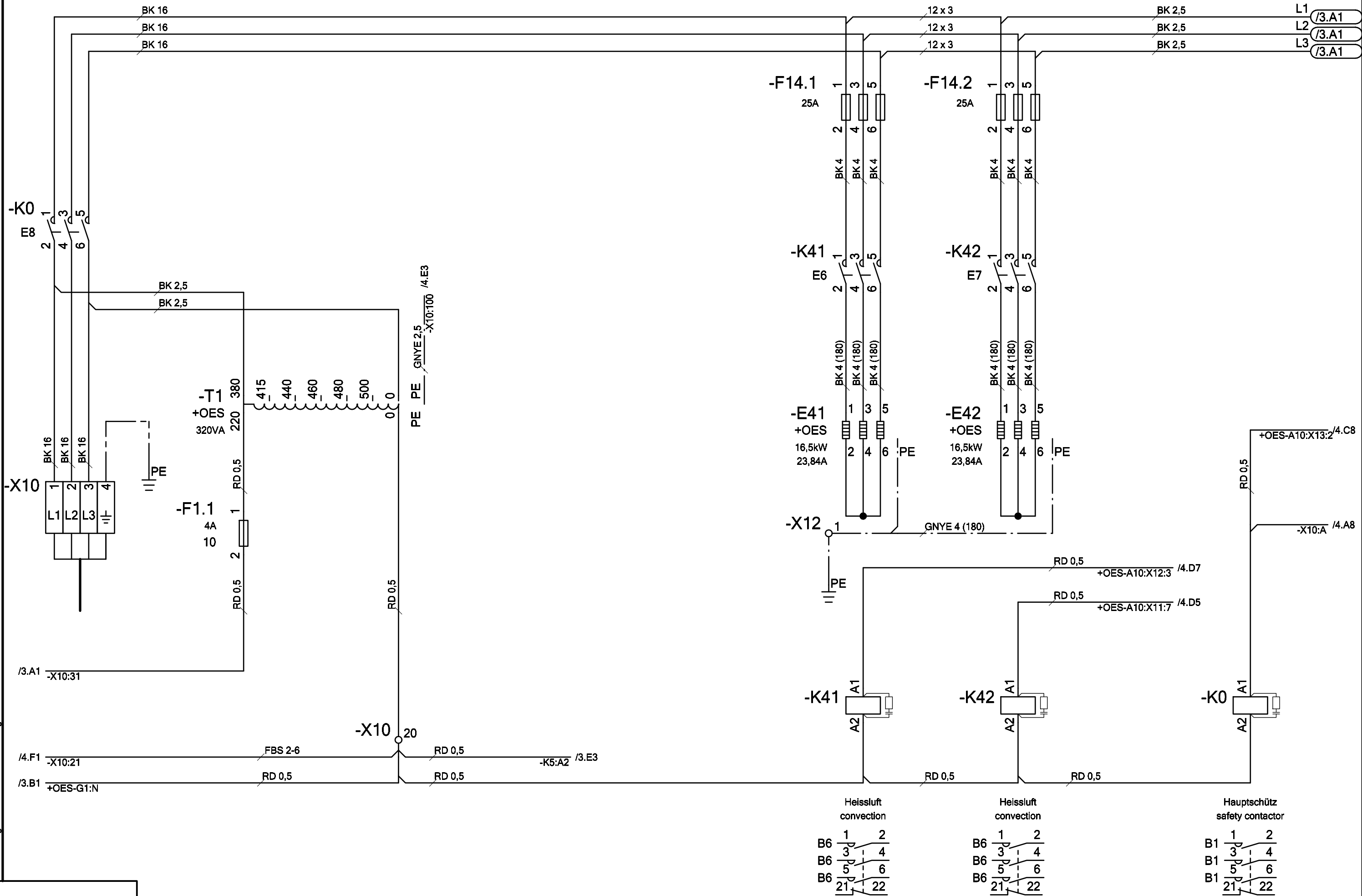

Schutzvermerk nach DIN 34 beachten !

Alle Leitungen ohne Querschnittsangabe sind mm²



|             |  |            |      |            |          |                     |            |                |                              |                   |  |         |  |
|-------------|--|------------|------|------------|----------|---------------------|------------|----------------|------------------------------|-------------------|--|---------|--|
| B ÄM75/07   |  | 20.08.2007 | KEE  | Bearbeiter | Böttiger | OES 12.20           |            | Stromlaufpläne |                              | 5115768 / 5315594 |  |         |  |
| A ÄM144/05  |  | 20.09.2005 | KEE  | Geprüft    | Huber    | 3/PE ~ 400V 50/60Hz |            | 2              |                              |                   |  | +MP     |  |
| R. Änderung |  | Datum      | Name | Norm       |          | Ursprung            | Ersatz für | Ersatz durch   | Heizungen / heating elements | 5115768 /5315594  |  | Blatt 2 |  |
| 1           |  | 2          |      |            |          |                     |            |                |                              |                   |  | 4 Bl.   |  |

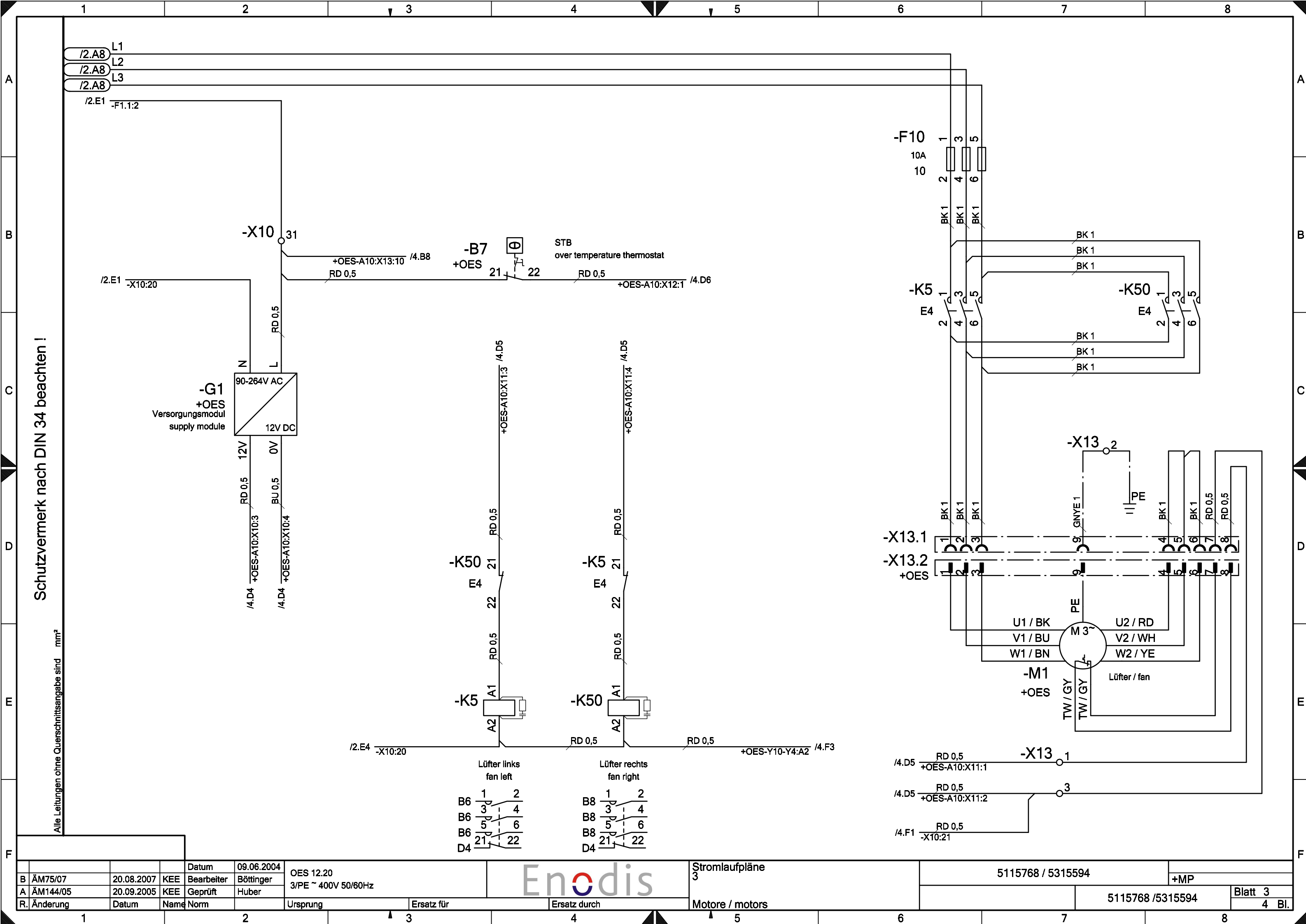

Schutzvermerk nach DIN 34 beachten !

Alle Leitungen ohne Querschnittsangaben sind mm<sup>2</sup>

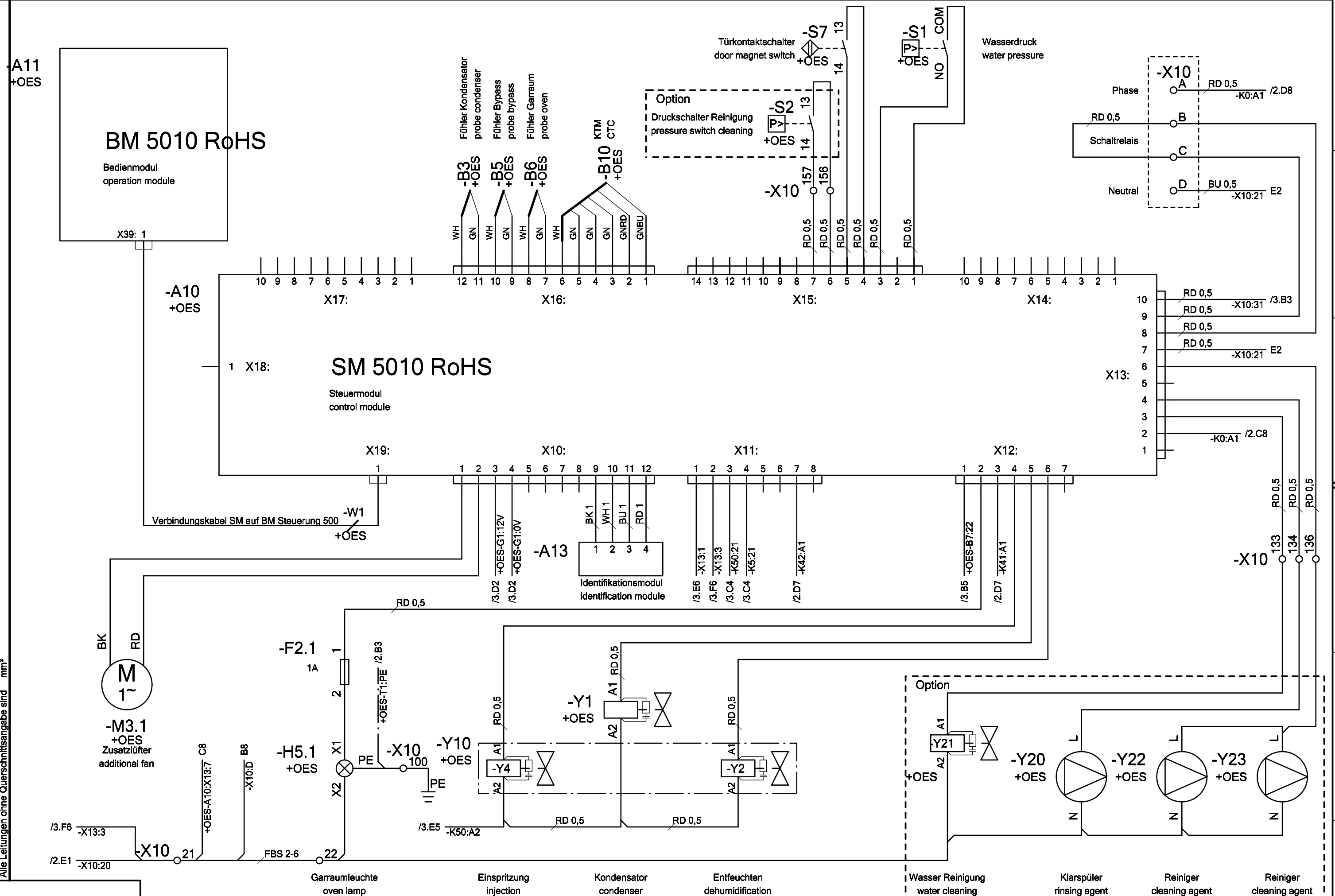

|             |       |            |      |            |            |                                  |  |                     |  |                     |  |                   |  |                  |  |
|-------------|-------|------------|------|------------|------------|----------------------------------|--|---------------------|--|---------------------|--|-------------------|--|------------------|--|
| B ÄM75/07   |       | 20.08.2007 | KEE  | Bearbeiter | Böttiger   | OES 12.20<br>3/PE ~ 400V 50/60Hz |  | Enodis              |  | Stromlaufpläne<br>4 |  | 5115768 / 5315594 |  | +MP              |  |
| A ÄM144/05  |       | 20.09.2005 | KEE  | Geprüft    | Huber      |                                  |  |                     |  |                     |  |                   |  |                  |  |
| R. Änderung | Datum | Name       | Norm | Ursprung   | Ersatz für | Ersatz durch                     |  | Steuerung / control |  | 5115768 / 5315594   |  | 5115768 / 5315594 |  | Blatt 4<br>4 Bl. |  |

Erstellt mit ELCAD/AUCOPLAN (R) 7.3.2 SP2

Schutzvermerk nach DIN 34 beachten !

| Ersatzteilliste/spare parts list/Liste des pièces de rechange/Lista des piezas de repuesto |       |   |            |           |            |  |                                       |   |  |                             |  |                   |  |       |  |
|--|-------|---|------------|-----------|------------|--|---------------------------------------|---|--|-----------------------------|--|-------------------|--|-------|--|
| Nr.  |       | Betriebsmittel/operating material/moyen de production/medio de producción |            |           |            | Bezeichnung                              | description                           | désignation   | designación                              |                             |  |                   |  |       |  |
|  |       | Artikelnummer/part number/numéro d'article/numero artículo                |            |           |            |  |                                       |   |  |                             |  |                   |  |       |  |
|  |       | Darstellung/presentation/présentation/representación                      |            |           |            |  |                                       |   |  |                             |  |                   |  |       |  |
| 1  |       |   |            |           |            | Steuerung 5010 RoHS SM P3                | electronic board 5010 RoHS SM P3      | commande électronique 5010 RoHS SM P3   | mando 5010 RoHS SM P3                    |                             |  |                   |  |       |  |
|  | +OES  | -A10  | 5019306    |           |            |  |                                       |   |  |                             |  |                   |  |       |  |
|  | /4.D3 |   |            |           |            |  |                                       |   |  |                             |  |                   |  |       |  |
| 2  |       |   |            |           |            | Steuerung 5010 RoHS BM P3                | electronic board 5010 RoHS BM P3      | commande électronique 5010 RoHS BM P3   | mando 5010 BM RoHS P3                    |                             |  |                   |  |       |  |
|  | +OES  | -A11  | 5019300    |           |            |  |                                       |   |  |                             |  |                   |  |       |  |
|  | /4.B2 |   |            |           |            |  |                                       |   |  |                             |  |                   |  |       |  |
| 3  |       |   |            |           |            | Steuerung 5010 Identifikationsmodul IDM  | electronic board 5010 IDM P3          | commande électronique 5010 IDM P3   | mando 5010 IDM P3                        |                             |  |                   |  |       |  |
|  | +MP   | -A13  | 5019301    |           |            |  |                                       |   |  |                             |  |                   |  |       |  |
|  | /4.D4 |   |            |           |            |  |                                       |   |  |                             |  |                   |  |       |  |
| 4  |       |   |            |           |            | Thermoelementfühler OSC/OSP 3050 mm P2   | Thermocouple probe OSC/OSP 3050 mm P2 | Thermocouple sonde OSC/OSP 3050 mm  | Termoelemento sonda OSC/OSP 3050 mm P2   |                             |  |                   |  |       |  |
|  | +OES  | -B3   | 5002100    |           |            |  |                                       |   |  |                             |  |                   |  |       |  |
|  | /4.B3 |   |            |           |            |  |                                       |   |  |                             |  |                   |  |       |  |
| 5  |       |   |            |           |            | Thermoelementfühler OSC/OSP 3050 mm P2   | Thermocouple probe OSC/OSP 3050 mm P2 | Thermocouple sonde OSC/OSP 3050 mm  | Termoelemento sonda OSC/OSP 3050 mm P2   |                             |  |                   |  |       |  |
|  | +OES  | -B5   | 5002100    |           |            |  |                                       |   |  |                             |  |                   |  |       |  |
|  | /4.B4 |   |            |           |            |  |                                       |   |  |                             |  |                   |  |       |  |
| 6  |       |   |            |           |            | Thermoelementfühler OSC/OSP 3050 mm P2   | Thermocouple probe OSC/OSP 3050 mm P2 | Thermocouple sonde OSC/OSP 3050 mm  | Termoelemento sonda OSC/OSP 3050 mm P2   |                             |  |                   |  |       |  |
|  | +OES  | -B6   | 5002100    |           |            |  |                                       |   |  |                             |  |                   |  |       |  |
|  | /4.B4 |   |            |           |            |  |                                       |   |  |                             |  |                   |  |       |  |
| 7  |       |   |            |           |            | Kerntemperatur-Meßfühler 4 Pkt. Ni-Cr-Ni | multi point CTC probe                 | Sàc des multi points  | sonda de temperatura central de 4 puntos |                             |  |                   |  |       |  |
|  | +OES  | -B10  | 5002068    |           |            |  |                                       |   |  |                             |  |                   |  |       |  |
|  | /4.B4 |   |            |           |            |  |                                       |   |  |                             |  |                   |  |       |  |
| 8  |       |   |            |           |            | RHK D490 Stern 2x16,5kW 230V             | heating element P3 2x16,5 kW          | resistance circulaire P3 2x16,5 kW  | radiator tubular P3 2x16,5 kW            |                             |  |                   |  |       |  |
|  | +OES  | -E41  | 5017000    |           |            |  |                                       |   |  |                             |  |                   |  |       |  |
|  | /2.C6 |   |            |           |            |  |                                       |   |  |                             |  |                   |  |       |  |
| 9  |       |   |            |           |            | RHK D490 Stern 2x16,5kW 230V             | heating element P3 2x16,5 kW          | resistance circulaire P3 2x16,5 kW  | radiator tubular P3 2x16,5 kW            |                             |  |                   |  |       |  |
|  | +OES  | -E42  | 5017000    |           |            |  |                                       |   |  |                             |  |                   |  |       |  |
|  | /2.C6 |   |            |           |            |  |                                       |   |  |                             |  |                   |  |       |  |
| 10   |       |   |            |           |            | Feinsicherung 5x20 4Af P3                | glass fuse 5x20 4Af P3                | fusible 5x20 4Af P3   | fusible 5x20 4Af P3                      |                             |  |                   |  |       |  |
|  | +MP   | -F1.1   | 4016002    |           |            |  |                                       |   |  |                             |  |                   |  |       |  |
|  | /2.D2 |   |            |           |            |  |                                       |   |  |                             |  |                   |  |       |  |
| 11   |       |   |            |           |            | Zackband flach unbedruckt                | sticker flat not printed (8,2)        | vignette plaine pas imprimée (8,2)  | etiqueta lisa non estampada (8,2)        |                             |  |                   |  |       |  |
|  | +MP   | -F1.1   | 4014038    |           |            |  |                                       |   |  |                             |  |                   |  |       |  |
|  | /2.D2 |   |            |           |            |  |                                       |   |  |                             |  |                   |  |       |  |
| 12   |       |   |            |           |            | Zugfeder-Drehsicherungsklemme            | cage clamp terminal block (5x20)      | pince ressort de traction (5x20)  | pinza resorte de tracción (5x20)         |                             |  |                   |  |       |  |
|  | +MP   | -F1.1   | 4014036    |           |            |  |                                       |   |  |                             |  |                   |  |       |  |
|  | /2.D2 |   |            |           |            |  |                                       |   |  |                             |  |                   |  |       |  |
| 13   |       |   |            |           |            | Feinsicherung 1A träge                   | glass fuse 1A                         | fusible 1A  | fusible 1A                               |                             |  |                   |  |       |  |
|  | +MP   | -F2.1   | 4005064    |           |            |  |                                       |   |  |                             |  |                   |  |       |  |
|  | /4.D3 |   |            |           |            |  |                                       |   |  |                             |  |                   |  |       |  |
| 14   |       |   |            |           |            | Zackband flach unbedruckt                | sticker flat not printed (8,2)        | vignette plaine pas imprimée (8,2)  | etiqueta lisa non estampada (8,2)        |                             |  |                   |  |       |  |
|  | +MP   | -F2.1   | 4014038    |           |            |  |                                       |   |  |                             |  |                   |  |       |  |
|  | /4.D3 |   |            |           |            |  |                                       |   |  |                             |  |                   |  |       |  |
| 15   |       |   |            |           |            | Zugfeder-Drehsicherungsklemme            | cage clamp terminal block (5x20)      | pince ressort de traction (5x20)  | pinza resorte de tracción (5x20)         |                             |  |                   |  |       |  |
|  | +MP   | -F2.1   | 4014036    |           |            |  |                                       |   |  |                             |  |                   |  |       |  |
|  | /4.D3 |   |            |           |            |  |                                       |   |  |                             |  |                   |  |       |  |
| 16   |       |   |            |           |            | Feinsicherung 10AF                       | glass fuse 10A                        | fusible 10A   | fusible 10A                              |                             |  |                   |  |       |  |
|  | +MP   | -F10  | 4005067    |           |            |  |                                       |   |  |                             |  |                   |  |       |  |
|  | /3.A6 |   |            |           |            |  |                                       |   |  |                             |  |                   |  |       |  |
| 17   |       |   |            |           |            | Zackband flach unbedruckt                | sticker flat not printed (8,2)        | vignette plaine pas imprimée (8,2)  | etiqueta lisa non estampada (8,2)        |                             |  |                   |  |       |  |
|  | +MP   | -F10  | 4014038    |           |            |  |                                       |   |  |                             |  |                   |  |       |  |
|  | /3.A6 |   |            |           |            |  |                                       |   |  |                             |  |                   |  |       |  |
| 18   |       |   |            |           |            | Zugfeder-Drehsicherungsklemme            | cage clamp terminal block (6,3x32)    | pince ressort de traction (6,3x32)  | pinza resorte de tracción (6,3x32)       |                             |  |                   |  |       |  |
|  | +MP   | -F10  | 4014037    |           |            |  |                                       |   |  |                             |  |                   |  |       |  |
|  | /3.A6 |   |            |           |            |  |                                       |   |  |                             |  |                   |  |       |  |
| 19   |       |   |            |           |            | Einbausicherungssockel-b 63A/400V        | fuse socket-b / flush 63A/400V NEOZED | socle de fusible-b 63A/400V NEOZED  | Zócalo de fusible-b 63A/400V NEOZED      |                             |  |                   |  |       |  |
|  | +MP   | -F14.1  | 4004023    |           |            |  |                                       |   |  |                             |  |                   |  |       |  |
|  | /2.A6 |   |            |           |            |  |                                       |   |  |                             |  |                   |  |       |  |
| 20   |       |   |            |           |            | Paßeinsatz 25A Neozed                    | Gauge piece 25A Neozed                | Insert pour fusible 25A Neozed  | Tornillo calibrado de fusibles 25A       |                             |  |                   |  |       |  |
|  | +MP   | -F14.1  | 4005015    |           |            |  |                                       |   |  |                             |  |                   |  |       |  |
|  | /2.A6 |   |            |           |            |  |                                       |   |  |                             |  |                   |  |       |  |
| Bemerkungen :  |       |   |            |           |            |  |                                       |   |  |                             |  |                   |  |       |  |
|  |       |   |            | Datum     | 09.08.2007 | OES 12.20<br>3/PE ~ 400V 50/60Hz         |                                       |  |  | Listen Ersatzteilliste<br>1 |  | 5115768 / 5315594 |  |       |  |
|  |       |   | Bearbeiter | Böttinger |            |  |                                       |   |  |                             |  |                   |  |       |  |
|  |       |   | Geprüft    |           |            |  |                                       |   |  |                             |  |                   |  |       |  |
| R. Änderung  |       | Datum   | Name       | Norm      |            | Ursprung                                 | Ersatz für                            | Ersatz durch  |  |                             |  | 5115768 / 5315594 |  | 4 Bl. |  |

Schutzvermerk nach DIN 34 beachten !

Erstellt mit ELCAD/AUCOPLAN (R) 7.3.2 SP2

Erstellt mit ELCAD/AUCOPLAN (R) 7.3.2 SP2

Schutzvermerk nach DIN 34 beachten !

| Ersatzteilliste/spare parts list/Liste des pièces de rechange/Lista des piezas de repuesto |       |   |            |           |            |  |  |   |  |                                |                   |                   |                  |  |  |
|--|-------|---|------------|-----------|------------|--|--|---|--|--------------------------------|-------------------|-------------------|------------------|--|--|
| Nr.  |       | Betriebsmittel/operating material/moyen de production/medio de producción |            |           |            | Bezeichnung                              | description                              | désignation   | designación                              |                                |                   |                   |                  |  |  |
|  |       | Artikelnummer/part number/numéro d'article/numero artículo                |            |           |            |  |  |   |  |                                |                   |                   |                  |  |  |
|  |       | Darstellung/presentation/présentation/representación                      |            |           |            |  |  |   |  |                                |                   |                   |                  |  |  |
| 21   |       |   |            |           |            | Schraubkappe 25-63 A Neozed              | Screw cap 25-63A Neozed                  | Capuchon p. socle de fusible 25-63A   | Portafusible 25-63A                      |                                |                   |                   |                  |  |  |
|  | +MP   | -F14.1  | 4004035    |           |            |  |  |   |  |                                |                   |                   |                  |  |  |
|  | /2.A6 |   |            |           |            |  |  |   |  |                                |                   |                   |                  |  |  |
| 22   |       |   |            |           |            | Einzelabdeckung Einbausicherungssockel   | cover for fuse socket                    | Bride pour fusible  | Cubierta de fudsible                     |                                |                   |                   |                  |  |  |
|  | +MP   | -F14.1  | 4004042    |           |            |  |  |   |  |                                |                   |                   |                  |  |  |
|  | /2.A6 |   |            |           |            |  |  |   |  |                                |                   |                   |                  |  |  |
| 23   |       |   |            |           |            | Sicherungseinsatz 25A Neozed             | neodysed fuse 25A/400V                   | fusible 25A/400V NEOZED   | fusible 25A/400V NEOZED                  |                                |                   |                   |                  |  |  |
|  | +MP   | -F14.1  | 4005055    |           |            |  |  |   |  |                                |                   |                   |                  |  |  |
|  | /2.A6 |   |            |           |            |  |  |   |  |                                |                   |                   |                  |  |  |
| 24   |       |   |            |           |            | Einbausicherungssockel-b 63A/400V        | fuse socket-b / flush 63A/400V NEOZED    | socle de fusible-b 63A/400V NEOZED  | Zócalo de fusible-b 63A/400V NEOZED      |                                |                   |                   |                  |  |  |
|  | +MP   | -F14.2  | 4004023    |           |            |  |  |   |  |                                |                   |                   |                  |  |  |
|  | /2.A6 |   |            |           |            |  |  |   |  |                                |                   |                   |                  |  |  |
| 25   |       |   |            |           |            | Paßeinsatz 25A Neozed                    | Gauge piece 25A Neozed                   | Insert pour fusible 25A Neozed  | Tornillo calibrado de fusibles 25A       |                                |                   |                   |                  |  |  |
|  | +MP   | -F14.2  | 4005015    |           |            |  |  |   |  |                                |                   |                   |                  |  |  |
|  | /2.A6 |   |            |           |            |  |  |   |  |                                |                   |                   |                  |  |  |
| 26   |       |   |            |           |            | Schraubkappe 25-63 A Neozed              | Screw cap 25-63A Neozed                  | Capuchon p. socle de fusible 25-63A   | Portafusible 25-63A                      |                                |                   |                   |                  |  |  |
|  | +MP   | -F14.2  | 4004035    |           |            |  |  |   |  |                                |                   |                   |                  |  |  |
|  | /2.A6 |   |            |           |            |  |  |   |  |                                |                   |                   |                  |  |  |
| 27   |       |   |            |           |            | Einzelabdeckung Einbausicherungssockel   | cover for fuse socket                    | Bride pour fusible  | Cubierta de fudsible                     |                                |                   |                   |                  |  |  |
|  | +MP   | -F14.2  | 4004042    |           |            |  |  |   |  |                                |                   |                   |                  |  |  |
|  | /2.A6 |   |            |           |            |  |  |   |  |                                |                   |                   |                  |  |  |
| 28   |       |   |            |           |            | Sicherungseinsatz 25A Neozed             | neodysed fuse 25A/400V                   | fusible 25A/400V NEOZED   | fusible 25A/400V NEOZED                  |                                |                   |                   |                  |  |  |
|  | +MP   | -F14.2  | 4005055    |           |            |  |  |   |  |                                |                   |                   |                  |  |  |
|  | /2.A6 |   |            |           |            |  |  |   |  |                                |                   |                   |                  |  |  |
| 29   |       |   |            |           |            | Steuerung 5000 VM (Versorgungsmodul) P   | Electronic board 5000 VM (Supply module) | Commande électronique 5000 VM   | Mando 5000 VM (Módulo de alimentación)   |                                |                   |                   |                  |  |  |
|  | +OES  | -G1   | 5009301    |           |            |  |  |   |  |                                |                   |                   |                  |  |  |
|  | /3.C2 |   |            |           |            |  |  |   |  |                                |                   |                   |                  |  |  |
| 30   |       |   |            |           |            | Reflektorgehäuse mit Lampe Garraumleucht | reflector case with lamp                 | boîtier réflecteur avec lampe   | caja de reflexion con lámpara            |                                |                   |                   |                  |  |  |
|  | +OES  | -H5.1   | 5015001    |           |            |  |  |   |  |                                |                   |                   |                  |  |  |
|  | /4.E3 |   |            |           |            |  |  |   |  |                                |                   |                   |                  |  |  |
| 31   |       |   |            |           |            | Glas für Garraumleuchte P3               | glass for lamp                           | verre pour lampe de   | cristal para luz del horno               |                                |                   |                   |                  |  |  |
|  | +OES  | -H5.1   | 5015002    |           |            |  |  |   |  |                                |                   |                   |                  |  |  |
|  | /4.E3 |   |            |           |            |  |  |   |  |                                |                   |                   |                  |  |  |
| 32   |       |   |            |           |            | Rahmen für Garraumleuchte P3             | frame for oven lamp                      | cadre pour lampe de   | bastidor para luz del horno              |                                |                   |                   |                  |  |  |
|  | +OES  | -H5.1   | 5015003    |           |            |  |  |   |  |                                |                   |                   |                  |  |  |
|  | /4.E3 |   |            |           |            |  |  |   |  |                                |                   |                   |                  |  |  |
| 33   |       |   |            |           |            | Dichtung Garraumleuchte P3               | Seal for oven lamp P3                    | Joint pour enceinte de cuisson P3   | Junta para luz del horno P3              |                                |                   |                   |                  |  |  |
|  | +OES  | -H5.1   | 6015020    |           |            |  |  |   |  |                                |                   |                   |                  |  |  |
|  | /4.E3 |   |            |           |            |  |  |   |  |                                |                   |                   |                  |  |  |
| 34   |       |   |            |           |            | RC-Glied 110-240V (D40-D150)             | interference filter 110-240V (D40-D150)  | filtre antiparasite 110-240V (D40-D150)   | filtro antiparasitario 110-240V D40-D150 |                                |                   |                   |                  |  |  |
|  | +MP   | -K0   | 4011010    |           |            |  |  |   |  |                                |                   |                   |                  |  |  |
|  | /2.E8 |   |            |           |            |  |  |   |  |                                |                   |                   |                  |  |  |
| 35   |       |   |            |           |            | Schütz 21 kW / 60 A                      | contactor 21 kW / 60 A                   | contacteur 21 kW / 60 A   | contactor 21 kW / 60 A                   |                                |                   |                   |                  |  |  |
|  | +MP   | -K0   | 4011011    |           |            |  |  |   |  |                                |                   |                   |                  |  |  |
|  | /2.E8 |   |            |           |            |  |  |   |  |                                |                   |                   |                  |  |  |
| 36   |       |   |            |           |            | RC-Glied 110-240V                        | interference filter 110-240V             | filtre antiparasite 110-240V  | filtro antiparasitario 110-240V          |                                |                   |                   |                  |  |  |
|  | +MP   | -K5   | 4011004    |           |            |  |  |   |  |                                |                   |                   |                  |  |  |
|  | /3.E4 |   |            |           |            |  |  |   |  |                                |                   |                   |                  |  |  |
| 37   |       |   |            |           |            | Schütz 9kW / 25A AC1                     | contactor 9kW / 25A AC1                  | contacteur 9kW / 25A AC1  | contactor 9kW / 25A AC1                  |                                |                   |                   |                  |  |  |
|  | +MP   | -K5   | 4011000    |           |            |  |  |   |  |                                |                   |                   |                  |  |  |
|  | /3.E4 |   |            |           |            |  |  |   |  |                                |                   |                   |                  |  |  |
| 38   |       |   |            |           |            | RC-Glied 110-240V                        | interference filter 110-240V             | filtre antiparasite 110-240V  | filtro antiparasitario 110-240V          |                                |                   |                   |                  |  |  |
|  | +MP   | -K41  | 4011004    |           |            |  |  |   |  |                                |                   |                   |                  |  |  |
|  | /2.E6 |   |            |           |            |  |  |   |  |                                |                   |                   |                  |  |  |
| 39   |       |   |            |           |            | Schütz 11kW/32A AC1                      | contactor 11kW/32A AC1                   | contacteur 11kW/32A AC1   | contactor 11kW/32A AC1                   |                                |                   |                   |                  |  |  |
|  | +MP   | -K41  | 4011001    |           |            |  |  |   |  |                                |                   |                   |                  |  |  |
|  | /2.E6 |   |            |           |            |  |  |   |  |                                |                   |                   |                  |  |  |
| 40   |       |   |            |           |            | RC-Glied 110-240V                        | interference filter 110-240V             | filtre antiparasite 110-240V  | filtro antiparasitario 110-240V          |                                |                   |                   |                  |  |  |
|  | +MP   | -K42  | 4011004    |           |            |  |  |   |  |                                |                   |                   |                  |  |  |
|  | /2.E7 |   |            |           |            |  |  |   |  |                                |                   |                   |                  |  |  |
| Bemerkungen :  |       |   |            |           |            |  |  |   |  |                                |                   |                   |                  |  |  |
|  |       |   |            | Datum     | 09.08.2007 | OES 12.20<br>3/PE ~ 400V 50/60Hz         |  |  |  | Listen<br>Ersatzteilliste<br>2 |                   | 5115768 / 5315594 |                  |  |  |
|  |       |   | Bearbeiter | Böttinger |            |  |  |   |  |                                |                   |                   |                  |  |  |
|  |       |   | Geprüft    |           |            |  |  |   |  |                                |                   |                   |                  |  |  |
| R. Änderung  |       | Datum   | Name       | Norm      |            | Ursprung                                 | Ersatz für                               | Ersatz durch  |  |                                | 5115768 / 5315594 |                   | Blatt 2<br>4 Bl. |  |  |

Erstellt mit ELCAD/AUCOPLAN (R) 7.3.2 SP2

Schutzvermerk nach DIN 34 beachten !

| Ersatzteilliste/spare parts list/Liste des pièces de rechange/Lista des piezas de repuesto |   |        |         |  |                                    |                                     |  |   |  |                                |  |                   |  |                  |  |
|--|---|--------|---------|--|------------------------------------|-------------------------------------|--|---|--|--------------------------------|--|-------------------|--|------------------|--|
| Nr.  | Betriebsmittel/operating material/moyen de production/medio de producción |        |         | Bezeichnung                              | description                        | désignation                         | designación                              |   |  |                                |  |                   |  |                  |  |
|  | Artikelnummer/part number/numéro d'article/numero artículo                |        |         |  |                                    |                                     |  |   |  |                                |  |                   |  |                  |  |
|  | Darstellung/presentation/présentation/representación                      |        |         |  |                                    |                                     |  |   |  |                                |  |                   |  |                  |  |
| 41   | +MP   | -K42   | 4011001 | Schütz 11kW/32A AC1                      | contactor 11kW/32A AC1             | contacteur 11kW/32A AC1             | contactor 11kW/32A AC1                   |   |  |                                |  |                   |  |                  |  |
|  | /2.E7   |        |         |  |                                    |                                     |  |   |  |                                |  |                   |  |                  |  |
| 42   | +MP   | -K50   | 4011004 | RC-Glied 110-240V                        | interference filter 110-240V       | filtre antiparasite 110-240V        | filtro antiparasitario 110-240V          |   |  |                                |  |                   |  |                  |  |
|  | /3.E4   |        |         |  |                                    |                                     |  |   |  |                                |  |                   |  |                  |  |
| 43   | +MP   | -K50   | 4011000 | Schütz 9kW / 25A AC1                     | contactor 9kW / 25A AC1            | contacteur 9kW / 25A AC1            | contactor 9kW / 25A AC1                  |   |  |                                |  |                   |  |                  |  |
|  | /3.E4   |        |         |  |                                    |                                     |  |   |  |                                |  |                   |  |                  |  |
| 44   | +OES  | -M1    | 5018020 | Drehstrommotor 4 pol. P3                 | AC motor 4 pol. P3                 | moteur AC 4 pol. P3                 | motor trifásico 4 pol. P3                |   |  |                                |  |                   |  |                  |  |
|  | /3.E7   |        |         |  |                                    |                                     |  |   |  |                                |  |                   |  |                  |  |
| 45   | +OES  | -M3.1  | 5018023 | Zusatzlüfter Sunon KD1212                | additional fan Sunon KD1212        | ventilateur additional Sunon KD1212 | ventilador adicional Sunon KD1212        |   |  |                                |  |                   |  |                  |  |
|  | /4.D1   |        |         |  |                                    |                                     |  |   |  |                                |  |                   |  |                  |  |
| 46   | +OES  | -S1    | 5009063 | Druckschalter neu ODgas (Wechsler)       | pressure switch                    | Interrupteur inv. manométrique      | Interrupteur de presión                  |   |  |                                |  |                   |  |                  |  |
|  | /4.A6   |        |         |  |                                    |                                     |  |   |  |                                |  |                   |  |                  |  |
| 47   | +OES  | -S2    | 5013051 | DS 200mbar M10x1 EPDM P3                 | Pressure switch for auto. cleaning | Interrupteur manométrique           | Interruptor autom por aumento de presión |   |  |                                |  |                   |  |                  |  |
|  | /4.A5   |        |         |  |                                    |                                     |  |   |  |                                |  |                   |  |                  |  |
| 48   | +OES  | -S7    | 5003075 | Türkontaktschalter berührungslos         | door magnet switch                 | interrupteur magnétique de porte    | interruptor magnético de puerta          |   |  |                                |  |                   |  |                  |  |
|  | /4.A6   |        |         |  |                                    |                                     |  |   |  |                                |  |                   |  |                  |  |
| 49   | +OES  | -T1    | 5002035 | Transformator 320 VA Spartrafo offen     | Transformer 320 VA                 | transformateur 320VA                | transformador 320VA                      |   |  |                                |  |                   |  |                  |  |
|  | /2.C2   |        |         |  |                                    |                                     |  |   |  |                                |  |                   |  |                  |  |
| 50   | +OES  | -W1    | 5009304 | Verbindungskabel SM auf BM Steuerung 500 | connection cable SM to BM          | cable d'alimentation SM-BM          | cable de conexión SM a BM                |   |  |                                |  |                   |  |                  |  |
|  | /4.D3   |        |         |  |                                    |                                     |  |   |  |                                |  |                   |  |                  |  |
| 51   | +MP   | -X10   | 5012003 | Stecker direkt 12pol. RM 3,5 mm P3       | terminal block 12pol. RM 3,5 mm P3 | connecteur 12pol. RM 3,5 mm P3      | conector 12pol. RM 3,5 mm P3             |   |  |                                |  |                   |  |                  |  |
|  | /4.C5   |        |         |  |                                    |                                     |  |   |  |                                |  |                   |  |                  |  |
| 52   | +MP   | -X11   | 5012002 | Stecker direkt 8pol. RM 5 mm P3          | terminal block 8pol. RM 5 mm P3    | connecteur 8pol. RM 5 mm P3         | conector 8pol. RM 5 mm P3                |   |  |                                |  |                   |  |                  |  |
|  | /4.C6   |        |         |  |                                    |                                     |  |   |  |                                |  |                   |  |                  |  |
| 53   | +MP   | -X12   | 5012001 | Stecker direkt 7pol. RM 5 mm P3          | terminal block 7pol. RM 5 mm P3    | connecteur 7pol. RM 5 mm P3         | conector 7pol. RM 5 mm P3                |   |  |                                |  |                   |  |                  |  |
|  | /4.C7   |        |         |  |                                    |                                     |  |   |  |                                |  |                   |  |                  |  |
| 54   | +MP   | -X13   | 5002094 | Stecker X2 direkt 10 pol. RM 5mm P2 P3   | terminal block 10 pol. RM 5 P2 P3  | connecteur 10 pol. RM 5 P2 P3       | conector X2 10 pol. RM 5 P2 P3           |   |  |                                |  |                   |  |                  |  |
|  | /4.B7   |        |         |  |                                    |                                     |  |   |  |                                |  |                   |  |                  |  |
| 55   | +MP   | -X13.1 | 4014071 | ST-Combi-Kupplung 9pol. P3               | ST-Combi coupler plug 9pol. P3     | ST-Combi fiche de couplage          | ST-Combi ficha de cumplimiento           |   |  |                                |  |                   |  |                  |  |
|  | /3.D6   |        |         |  |                                    |                                     |  |   |  |                                |  |                   |  |                  |  |
| 56   | +MP   | -X13.1 | 4014040 | Zackband flach unbedruckt                | sticker flat not printed (5,2)     | vignette plaine pas imprimée (5,2)  | etiqueta lisa non estampada (5,2)        |   |  |                                |  |                   |  |                  |  |
|  | /3.D6   |        |         |  |                                    |                                     |  |   |  |                                |  |                   |  |                  |  |
| 57   | +OES  | -X13.2 | 4014072 | ST-Combi-Stecker 9pol. P3                | ST-Combi plug 9pol. P3             | ST-Combi connecteur                 | ST-Combi connecteur                      |   |  |                                |  |                   |  |                  |  |
|  | /3.D6   |        |         |  |                                    |                                     |  |   |  |                                |  |                   |  |                  |  |
| 58   | +MP   | -X15   | 5012003 | Stecker direkt 12pol. RM 3,5 mm P3       | terminal block 12pol. RM 3,5 mm P3 | connecteur 12pol. RM 3,5 mm P3      | conector 12pol. RM 3,5 mm P3             |   |  |                                |  |                   |  |                  |  |
|  | /4.B5   |        |         |  |                                    |                                     |  |   |  |                                |  |                   |  |                  |  |
| 59   | +OES  | -X16   | 5012003 | Stecker direkt 12pol. RM 3,5 mm P3       | terminal block 12pol. RM 3,5 mm P3 | connecteur 12pol. RM 3,5 mm P3      | conector 12pol. RM 3,5 mm P3             |   |  |                                |  |                   |  |                  |  |
|  | /4.B3   |        |         |  |                                    |                                     |  |   |  |                                |  |                   |  |                  |  |
| 60   | +OES  | -Y1    | 5001059 | Einfachmagnetventil 220-240V 180° ODgas  | solenoid valve                     | electrovanne simple                 | válvula magnética                        |   |  |                                |  |                   |  |                  |  |
|  | /4.E4   |        |         |  |                                    |                                     |  |   |  |                                |  |                   |  |                  |  |
| Bemerkungen :  |   |        |         |  |                                    |                                     |  |   |  |                                |  |                   |  |                  |  |
|  |   |        |         |  |                                    |                                     |  |   |  |                                |  |                   |  |                  |  |
|  |   |        |         | Datum                                    | 09.08.2007                         | OES 12.20<br>3/PE ~ 400V 50/60Hz    |  |  |  | Listen<br>Ersatzteilliste<br>3 |  | 5115768 / 5315594 |  |                  |  |
|  |   |        |         | Bearbeiter                               | Böttiger                           |                                     |  |   |  |                                |  |                   |  |                  |  |
|  |   |        |         | Geprüft                                  |                                    |                                     |  |   |  |                                |  |                   |  |                  |  |
| R. Änderung  |   | Datum  | Name    | Norm                                     |                                    | Ursprung                            | Ersatz für                               | Ersatz durch  |  |                                |  | 5115768 / 5315594 |  | Blatt 3<br>4 Bl. |  |

Schutzvermerk nach DIN 34 beachten !

Erstellt mit ELCAD/AUCOPLAN (R) 7.3.2 SP2

Listen  
Ersatzteilliste  
3

Ersatzteilliste/spare parts list/Liste des pièces de rechange/Lista des piezas de repuesto

| Nr. | Betriebsmittel/operating material/moyen de production/medio de producción |      |         | Bezeichnung                              | description                          | désignation                             | designación                             |
|-----|---|------|---------|--|--------------------------------------|---|---|
|     | Artikelnummer/part number/numéro d'article/numero articulo                |      |         |  |                                      |   |   |
|     | Darstellung/presentation/présentation/representación                      |      |         |  |                                      |   |   |
| 61  | +OES  | -Y1  | 4001075 | Entstörfilter-Magnetventil 240V          | Interference filter f.solenoid valve | filtre antiparasite electrovanne        | Filtro antiparasitario p. válvua        |
|     | /4.E4   |      |         |  |                                      |   |   |
| 62  | +OES  | -Y10 | 5001080 | Doppelmagnetventil 220-240V 50/60Hz 180° | double solenoid valve                | electrovanne double                     | válvula magnética doble                 |
|     | /4.E4   |      |         |  |                                      |   |   |
| 63  | +OES  | -Y10 | 4001075 | Entstörfilter-Magnetventil 240V          | Interference filter f.solenoid valve | filtre antiparasite electrovanne        | Filtro antiparasitario p. válvua        |
|     | /4.E4   |      |         |  |                                      |   |   |
| 64  | +OES  | -Y20 | 5018028 | Schwingkolbenpumpe MOD CP6 230V P3       | Swung ram pump MOD CP6 230V P3       | Pompe au Piston balancé MOD CP6 230V P3 | Bomba a piston agitomte MOD CP6 230V P3 |
|     | /4.E7   |      |         |  |                                      |   |   |
| 65  | +OES  | -Y22 | 5018028 | Schwingkolbenpumpe MOD CP6 230V P3       | Swung ram pump MOD CP6 230V P3       | Pompe au Piston balancé MOD CP6 230V P3 | Bomba a piston agitomte MOD CP6 230V P3 |
|     | /4.E8   |      |         |  |                                      |   |   |
| 66  | +OES  | -Y23 | 5018028 | Schwingkolbenpumpe MOD CP6 230V P3       | Swung ram pump MOD CP6 230V P3       | Pompe au Piston balancé MOD CP6 230V P3 | Bomba a piston agitomte MOD CP6 230V P3 |
|     | /4.E8   |      |         |  |                                      |   |   |

Schutzvermerk nach DIN 34 beachten !

Bemerkungen :



Erstellt mit ELCAD/AUCOPLAN (R) 7.3.2 SP2

Alle Leitungen ohne Querschnittsangabe sind mm²

Schutzvermerk nach DIN 34 beachten !

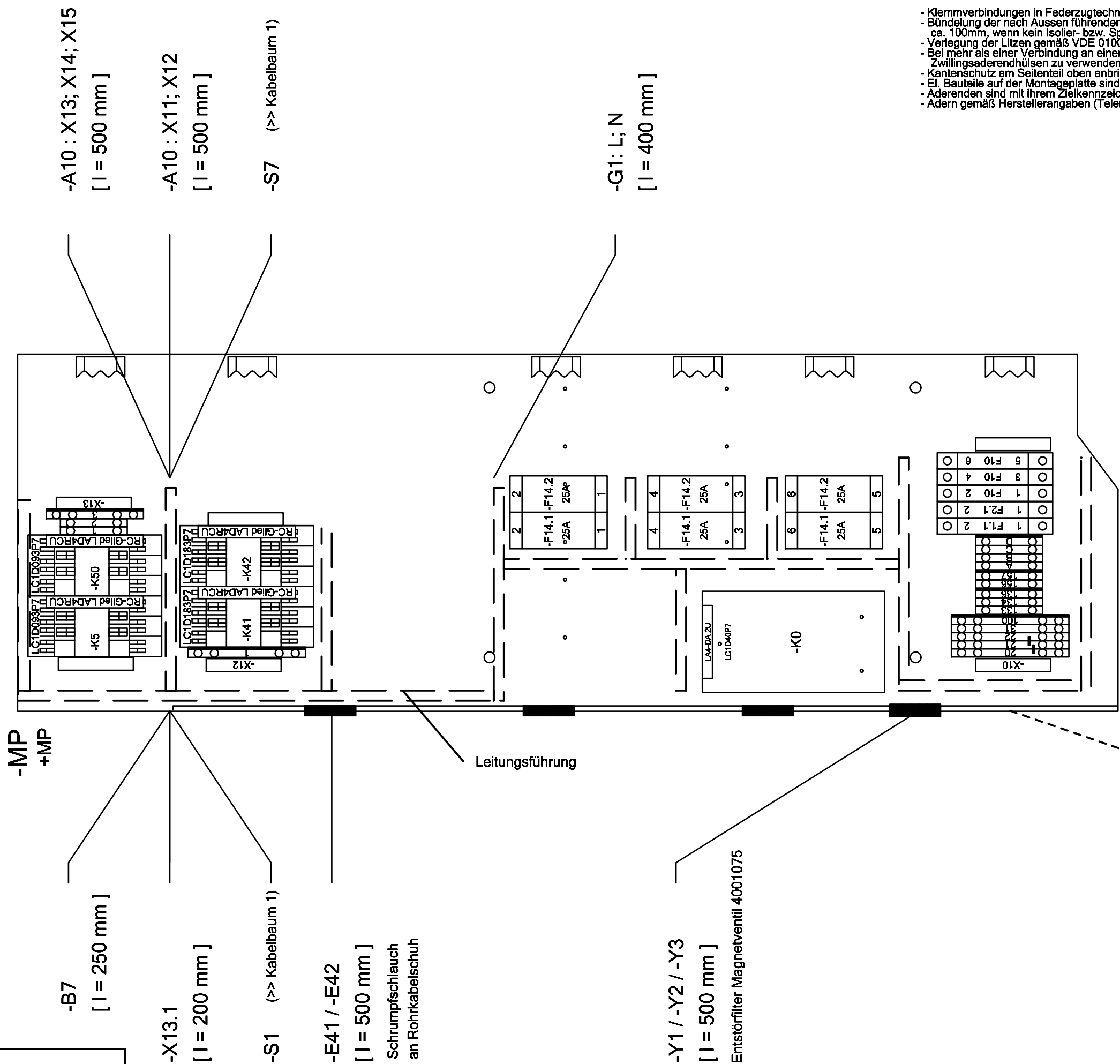

- Klemmverbindungen in Federzugtechnik ohne Aderendhülsen!
- Bündelung der nach Aussen führenden Litzen mit Kabelbindern im Abstand von ca. 100mm, wenn kein Isolier- bzw. Spiralschlauch vorgesehen ist!
- Verlegung der Litzen gemäß VDE 0100 Teil520!
- Bei mehr als einer Verbindung an einer Klemmstelle (z. B. Direktstecker) sind Zwillingsaderendhülsen zu verwenden!
- Kantenschutz am Seitenteil oben anbringen!
- El. Bauteile auf der Montageplatte sind maschinell zu Kennzeichnen!
- Aderenden sind mit ihrem Zielkennzeichen gut leserlich zu beschriften!
- Adern gemäß Herstellerangaben (Telemecanique / Phoenix Contact) abisolieren!

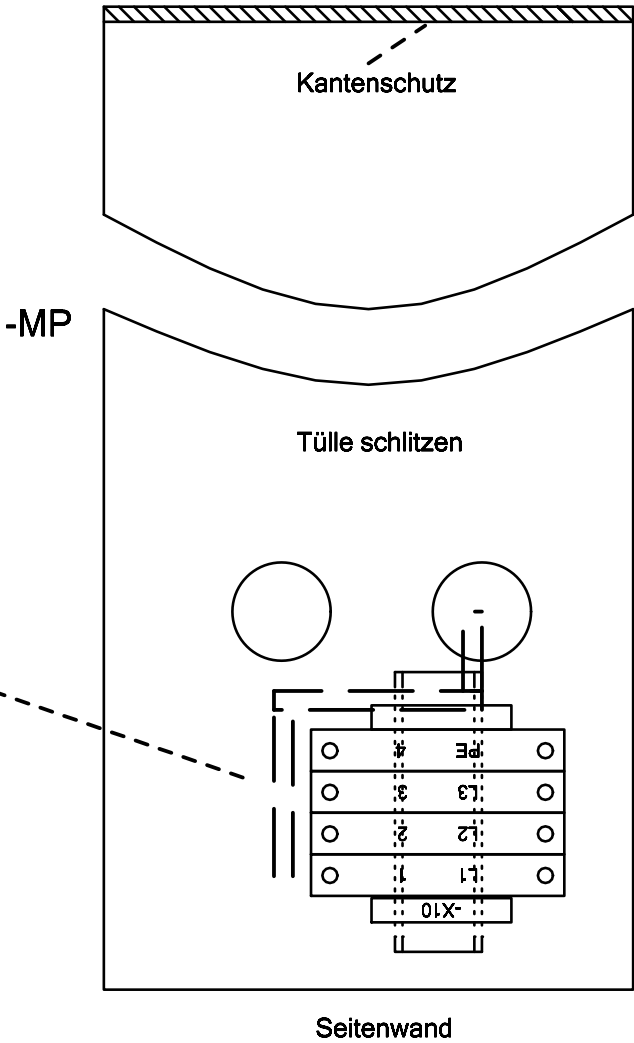

Skalierung Maßstab : 1:3  
Maßeinheit : mm

|    |          |            |      |            |          |
|----|----------|------------|------|------------|----------|
| B  | ÄM75/07  | 20.08.2007 | KEE  | Bearbeiter | Böttiger |
| A  | ÄM144/05 | 20.09.2005 | KEE  | Geprüft    | Huber    |
| R. | Änderung | Datum      | Name | Norm       |          |

OES 12.20  
3/PE ~ 400V 50/60Hz

Enodis

Aufbaupläne  
1

5115768 / 5315594

5115768 / 5315594

Blatt 1  
5 Bl.